

| | |
|---------------|-------------------------|
| B-2000-0160-1 | |
| SYM | REVISIONS |
| A | Released for Production |
| APPROVED | DATE |
| SAM | 11/08/02 |

Typical installation Voltmeter mounted vertically on the right side of instrument panel.

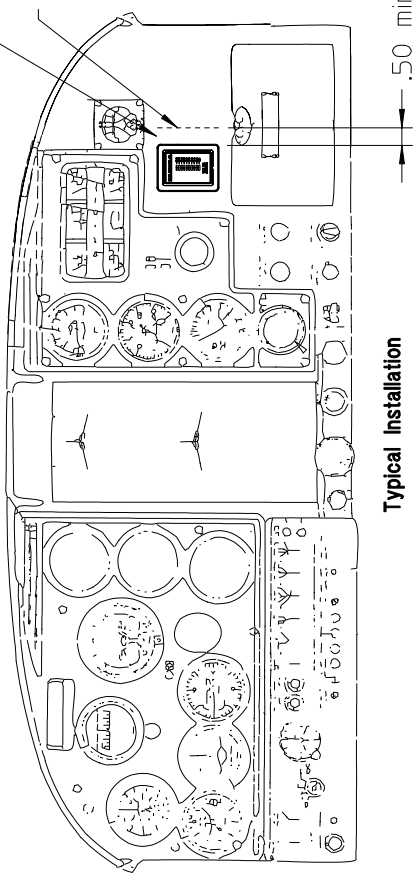

Typical Installation

Locate a minimum of 1/2" to the nearest device to avoid obstructing Pilots view of adjoining instruments.

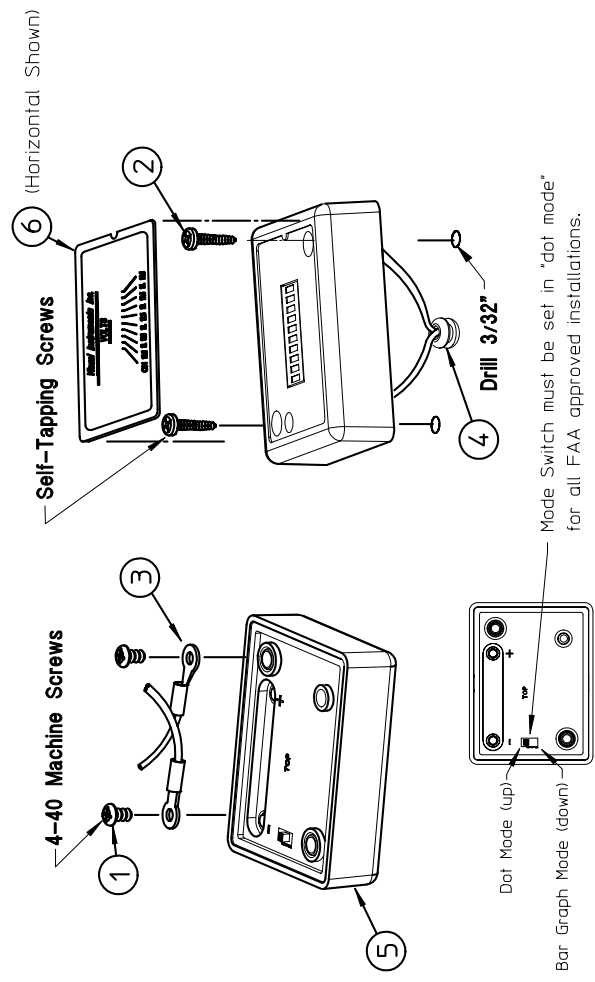

Dot Mode (up)
Bar Graph Mode (down)
Mode Switch must be set in "dot mode" for all FAA approved installations.

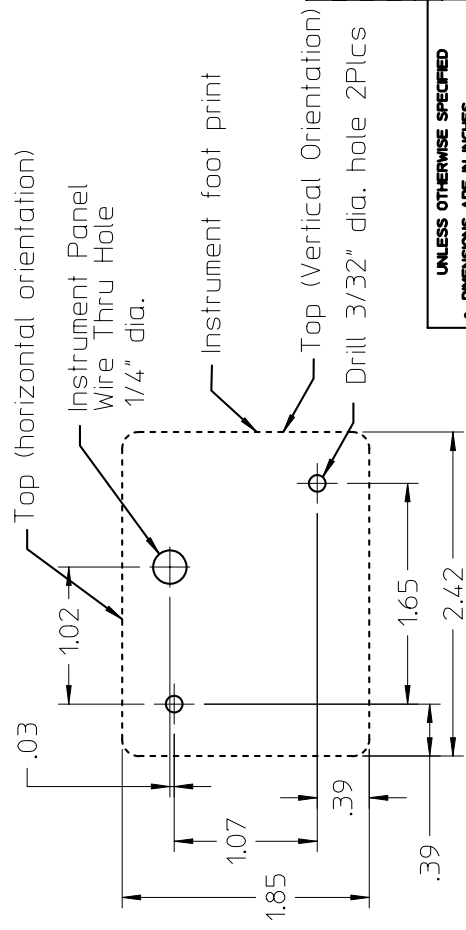

Drill Pattern

THIS DOCUMENT CONTAINS CONFIDENTIAL, PROPRIETARY INFORMATION THAT IS VISUAL INSTRUMENTS (VI) PROPERTY. DO NOT DISCLOSE TO OR DUPLICATE FOR OTHERS EXCEPT AS AUTHORIZED BY VI.

| | | | | |
|------|------|--|--------------------|------------------------|
| 6 | 1 | 12V Label Set | 2000-0170 | B-2000-0170-1 |
| 5 | 1 | Instrument Assembly | 2000-2600 | B-2000-2600-1 |
| 4 | 1 | Grommet 5/32ID X 3/8od for .250 dia hole | 2000-5001 | B-2000-5001-1 |
| 3 | 2 | Ring Terminal #4 | 2000-5002 | B-2000-5002-1 |
| 2 | 2 | Tapping Screw 4X.75 sms phil 18-8 SS pan | 2000-5003 | B-2000-5003-1 |
| 1 | 2 | 4-40 Machine screws 1/4" pan Posi SS | 2000-5004 | B-2000-5004-1 |
| ITEM | QTY. | PART/MATERIAL-DESCRIPTION | Visual Part Number | Control Drawing Number |

| | | | |
|-----------------------------------|----------|-----------------------------------|---------------------------|
| Steve Mahoney | 03/07/96 | 12 V Voltmeter Installation | Visual Instruments Inc |
| Steve Mahoney ENGINEER/CHECKER | 03/07/96 | | |
| RELEASE TO PROD. | | TITLE | PART NUMBER |
| '2000-0160_revA.mi | X .75 | SCALE | 2000-0160 |
| FILE | 1 | SHEET | 2 |
| | | OF | |

| | |
|---------------|--|
| B-2000-0160-1 | |
|---------------|--|