

NOTES: (UNLESS OTHERWISE SPECIFIED)

1. Lightly Debur all sharp edges (laser cut edge ok)
2. Etch and clear Chromate optional
3. Approximation of .63 R with straight punch acceptable.

B-6000-0200-1			
SYM	REVISIONS	APPROVED	DATE
B	Fabrication PCO 2000-6	SAM	7/27/00

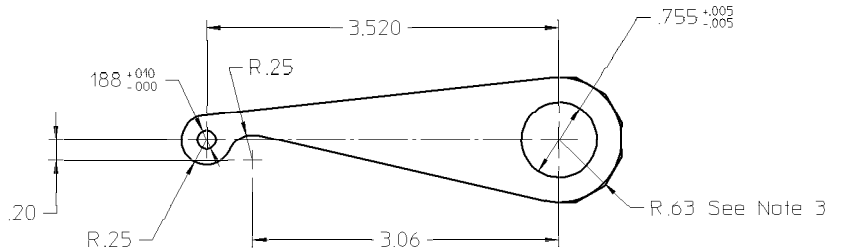

THIS DOCUMENT CONTAINS CONFIDENTIAL, PROPRIETARY INFORMATION THAT IS VISUAL INSTRUMENTS (VI) PROPERTY. DO NOT DISCLOSE TO OR DUPLICATE FOR OTHERS EXCEPT AS AUTHORIZED BY VI.

UNLESS OTHERWISE SPECIFIED		1	A/R	.080 Thick Aluminum 5052 . 6061-T6, or 2024-T3		Vendor	Vendor Part No.	Price
• DIMENSIONS ARE IN INCHES	• THIRD ANGLE PROJECTION	QTY.	REVISION	PART/MATERIAL-DESCRIPTION		TITLE		
• TOLERANCES	 .XX+.02 .XXXX.010 DO NOT SCALE THIS DRAWING		Steve Mahoney	03/07/96	Wing Flaps Sender Arm		Visual Instruments Inc	
		DRAWN BY	DATE					
	STRIKE OUT OR FILL IN AS NEEDED		Steve Mahoney	03/07/96	6000-0200_rev_b		PART NUMBER	
		RELEASE TO PROD.	ENGINEER/CHECKER	FILE			FULL SCALE	1 SHEET