

NOTES: (UNLESS OTHERWISE SPECIFIED)

1. Torque all 6-32 cap screws (Item 13) 8-12 inch-lbs
2. Torque 6-32 set screw (Item 12) to 6-10 inch-lbs
3. Torque 3/8 Nut on Item 2 to 6-8 inch-lbs
4. Position spindle (Item 11) so that it is flush to .04" from the end of the Potentiometer shaft.
5. Length of wires, Item 15, are 11" before stripping.

B-6000-0500-1			
SYM	REVISIONS	APPROVED	DATE
B	PCO #2000-1 Item 9 Retaining washer part number 6000-0150 was 6000-0300	SAM	04/03/00

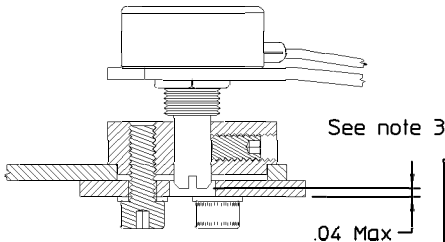
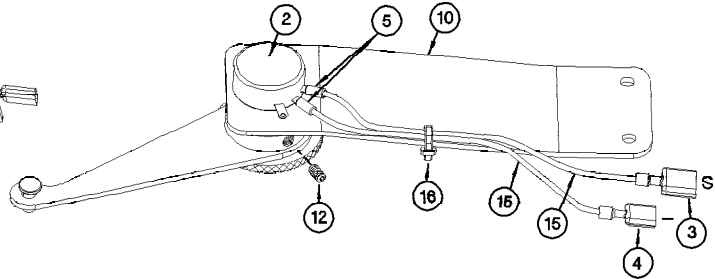
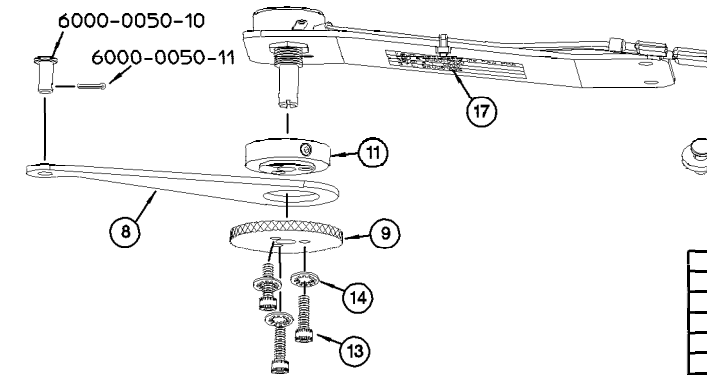

THIS DOCUMENT CONTAINS CONFIDENTIAL, PROPRIETARY INFORMATION THAT IS VISUAL INSTRUMENTS (VI) PROPERTY. DO NOT DISCLOSE TO OR DUPLICATE FOR OTHERS EXCEPT AS AUTHORIZED BY VI.

UNLESS OTHERWISE SPECIFIED
 • DIMENSIONS ARE IN INCHES
 • THIRD ANGLE PROJECTION
 • TOLERANCES
 .XX+.02
 .XXX+.005
 DO NOT SCALE THIS DRAWING

STRIKE OUT OR FILL IN AS NEEDED

ITEM	QTY.	PART/MATERIAL-DESCRIPTION	Vendor	Vendor Part No.	Visual Part Number
17	1	Serial, Part Number, PHA TAG	Computer Imprintable Labels	AL9-9200	6000-0500-17
16	1	Tie Wrap	Columbia Airmotive	TY 523M	6000-0500-16
15	22'	Wire #20 AWG 80deg UL1015 300volt white	DigKey	AZ102W-100-ND	6000-0500-15
14	3	Internal Lock Washer #6 410ss or zinc plated steel	Any satisfactory source	06w410	6000-0500-14
13	3	6-32 X 3/8" socket head cap screw	Any satisfactory source		6000-0500-13
12	1	6-32 X 1/4" socket set screw - cup point	Any satisfactory source		6000-0500-12
11	1	Spindle	Fabricated	6000-0100	
10	1	Housing Bracket	Fabricated	6000-0400	
9	1	Retainia Washer	Fabricated	6000-0150	
8	1	Flap Arm	Fabricated	6000-0200	
	1w	Coiler pin 1/16"	Columbia Airmotive	MS 24665-132	6000-0050-10
	1w	Clevis Pin 3/16 dia MS 20392-2C9	Columbia Airmotive	MS 20392-2C9	6000-0050-11
5	A/R	Heat Shrink 1/8 dia	DigKey	SFTW2018K-X-ND	6000-0500-5
4	1	Terminal 3M Female .187 wide	DigKey	920044-01 ND	6000-0500-4
3	1	Terminal 3M Male .187 wide	DigKey	920046-01-ND	6000-0500-3
2	1	Potentiometer 3852A 2 watt Cermet	DigKey	3852A-282-102A-ND	6000-0500-2

Steve Mahoney DRAWN BY	09/22/99 DATE	Wing Flaps Sender Assembly	<i>Visual Instruments Inc</i>		
Steve Mahoney ENGINEER/CHECKER	09/22/99		PART NUMBER 6000-0500		
RELEASE TO PROD.	6000-0500_REV_B5 FILE	x .8 SCALE	1 SHEET	1 OF	B-6000-0500-1